

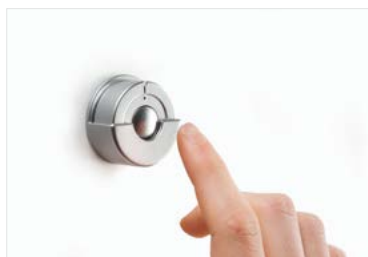

DOMUS Accessories

# DOMUS ACCESSORIES





DOMUS Line is an Italian company specialized in the designing and production of lighting devices for the furniture industry.

Six brands put together the widest offer of lighting systems and control devices of the furniture lighting sector.

Ongoing research, innovation, design, reliability and brand reputation are the distinctive values of our company.

## About us



Luminaires for kitchens, livingrooms and bedrooms



Architectural luminaires for bathrooms



Luminaires for classic furniture



Commercial lighting



Luminaires UL and CSA approved for USA and Canada



Sensors and LED converters

## Quality, environment and safety



The international standard ISO 9001 outlines the way to achieve high performance by following processes that improve operational efficiency at all levels. ISO 9001 is the most popular standard in the world, because it ensures the quality of processes, providing organizations with a competitive advantage. DOMUS Line has been ISO9001 certified for many years and has entrusted an entity among the most prestigious in the world to carry out periodic checks.



The international standard ISO 14001 is a management system recognized around the world that provides a framework for managing environmental performance. This standard is designed to help companies maintain high business value and, at the same time, effectively manage environmental responsibility. The recent certification of DOMUS Line ensures the company's commitment to continuous improvement and respect for the environment.



The ETL brand (Electrical Testing Laboratories) indicates that the product has been tested in accordance with the applicable product standards (ANSI, UL, CSA, ASTM, NFPA) so as to be sold in North America. DOMUS Line offers a wide range of products certified according to this standard, and then traded in compliance with the law in USA and Canada.



### CALL ME FW

wireless dimmable switch

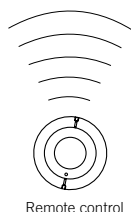
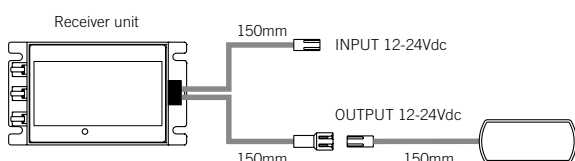

Remote control

Code	Input	Output	Power	Finish
1742101	12 - 24Vdc	12 - 24Vdc	36 - 72W	white
1742110	12 - 24Vdc	12 - 24Vdc	36 - 72W	aluminium
1742119	12 - 24Vdc	12 - 24Vdc	36 - 72W	steel



white



aluminium



steel

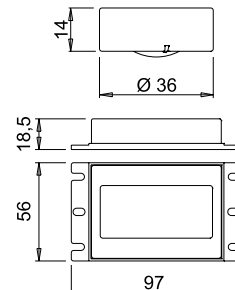

### How CALL ME works

Switching on and switching off take place simply by pressing the remote control key of CALL ME FW. With an extended touch, it is possible to adjust the light intensity (dimmer function). A short flash of the device connected to CALL ME FW indicates having reached the maximum light. The light level will be stored until the next adjustment (level memory).

CALL ME FW is provided with a security programme that switches off the device connected to it, after 18 hours of continuous operation. In addition, CALL ME FW is equipped with auto-on function that allows the automatic switching on of the device as soon as it receives power from the mains through the power supply.

On request, two holders for recessed installation on wood panels of CALL ME FW are available.

2011601 white  
2011610 aluminium  
2011619 steel

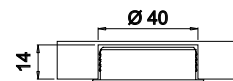

### TOUCH ME FW

TouchLed dimmable switch

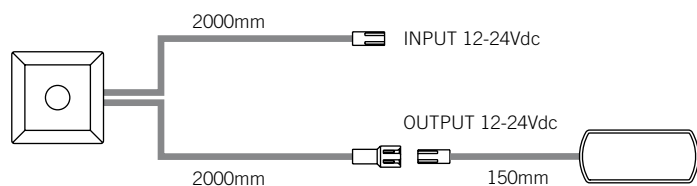

white



aluminium

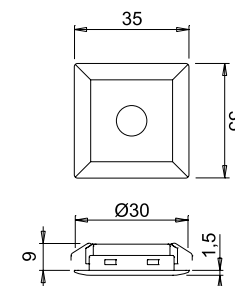

### How TOUCH ME works

The switching on and switching off of the devices connected to TOUCH ME FW takes place simply with a quick touch of the LED. With an extended touch it is possible to adjust the light intensity (dimmer function). A short flash of the device connected to TOUCH ME FW indicates having reached the maximum light. The light level will be stored until the next adjustment (level memory). TOUCH ME FW also integrates the "night-light" function which is activated only when the devices are switched off. At normal room light the LED emits a soft glow. With low or no room light TOUCH ME FW emits a brighter light. During operation of the devices, the light emitted by the TOUCH ME FW LED will be proportional to their adjustment. The "night-light" function can be disconnected or connected with a prolonged touch of 15 seconds at the end of which the disconnection of the function will be signalled by 2 short flashes or the insertion of 3 quick flashes.

TOUCH ME FW is provided with a security programme that switches off the devices connected to it after 18 hours of continuous operation.



**CAPSENS FW**  
capacitive dimmable switch



Code	Input	Output	Power	Finish
1741903	12 - 24Vdc	12 - 24Vdc	30 - 60W	black

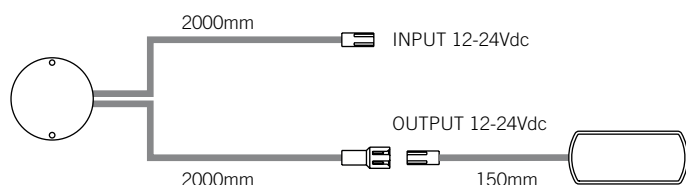
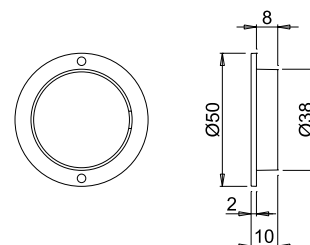

### How CAPSENS FW works

Switching on and switching off takes place simply through hand contact with the surface beneath which has been applied CAPSENS FW. With an extended touch it is possible to adjust the light intensity (dimmer function). A brief flash with the device connected to CAPSENS FW indicates of having reached the maximum light. The light level will be stored until the next adjustment (level memory). CAPSENS FW is provided with a security programme that switches off the devices connected to it after 18 hours of continuous operation. CAPSENS FW also is equipped with auto-on function that allows the automatic switching on of the device as soon as it receives power from the mains through the power supply.

### IP44 splash protection



CAPSENS FW is a device with IP44 degree protection.



wood



plexiglass



glass

CAPSENS FW is a special capacitive electronic switch designed to be applied at the rear of surfaces (such as, for example, wood, plastic, glass and other non-metallic materials, both opaque and transparent).

Materials	max H
wood	30mm
plexiglass	20mm
glass	12mm

The data are indicative and the sensitivity of CAPSENS FW may increase or decrease in relation to the composition of the materials. CAPSENS FW cannot be installed on metal surfaces. For other materials (such as, for example, granite, marble and composite materials), it is recommended to carry out a preliminary test. The "activation" area is about 50 mm diameter.



**DOT FW**  
touch dimmable switch

CE  

Code	Input	Output	Power	Finish
1743305	12 - 24Vdc	12 - 24Vdc	36 - 72W	aluminium

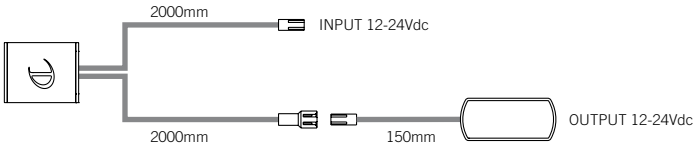
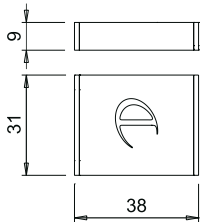

**How DOT FW works**

Switching on and switching off of the devices connected to DOT takes place simply with a quick touch. With an extended touch it is possible to adjust the light intensity (dimmer function).



**DOT IR FW**  
infrared proximity sensor

CE  

Code	Input	Output	Power	Finish
1743405	12 - 24Vdc	12 - 24Vdc	36 - 72W	aluminium

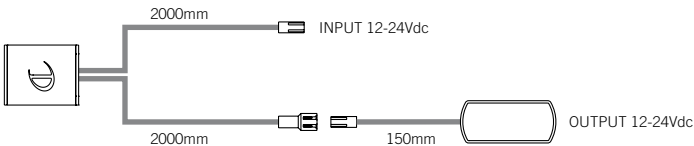
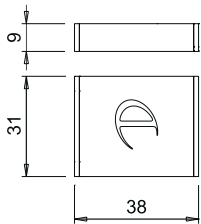

**How DOT IR FW works**

DOT IR is an infrared sensor with limit-switch function for inside cabinet installation. Switching on and switching off of the devices connected to DOT IR FW take place with the opening and closing with the door that is located in front of the sensor and at a distance not more than 10 cm.

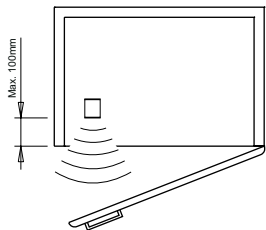



### IR 12/24 FW

infrared sensor with limit-switch or on-off function



Code	Model	Input	Output	Power	Finish
0854401	limit switch	12 - 24Vdc	12 - 24Vdc	15 - 30W	white

IR 12/24 is an infrared electronic sensor for 12Vdc and 24Vdc LED that can be installed both on surface or built-in.

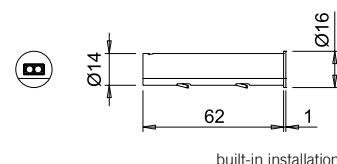

built-in installation

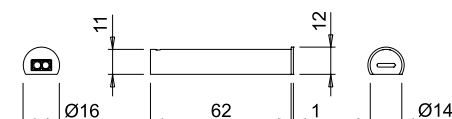

surface installation

### How IR 12/24 FW works

Limit switch standard set-up of IR 12/24 switches on and switches off the device connected to it when a door is located in front of the sensor and at a distance not more than 50 mm.



IR 12/24 set up can be changed by pressing the key for 3 seconds and therefore transform IR 12/24 in an on-off switch. For a perfect operation of IR 12/24 it is recommended to avoid use of white reflecting objects, shiny or reflective surfaces.

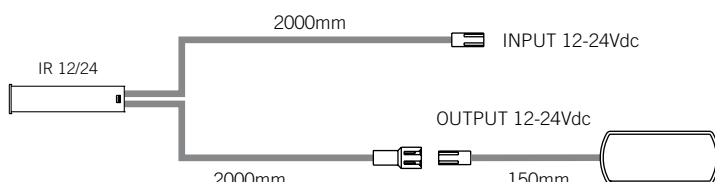

### IFR V09

PIR sensor

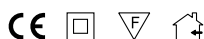

Code	Input	Output	Power	Finish
0854501	220 - 240Vac	220 - 240Vac	max 250W	white



WITH ADJUSTMENT OF THE SWITCHING OFF TIME DELAY FROM A MIN. OF 10 SECONDS TO A MAX. OF 3 MINUTES

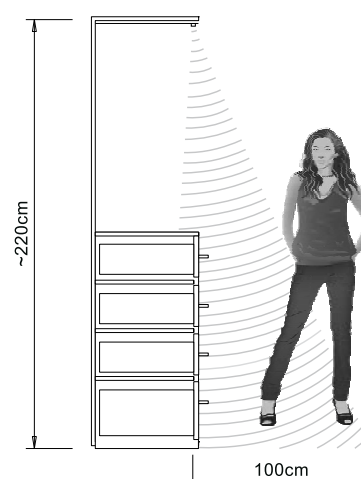
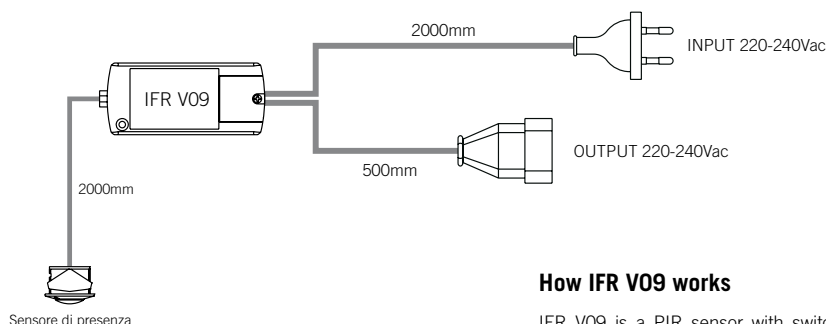
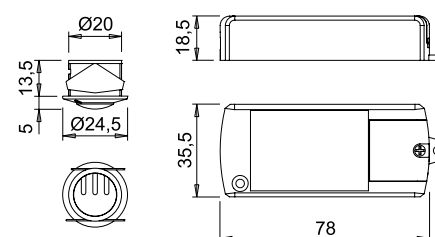

### How IFR V09 works

IFR V09 is a PIR sensor with switch function. IFR V09 can be used with all lighting devices. Switching on and switching off of the IFR V09 connected devices takes place through detection of the changes in temperature combined with the movement within its range of action. The system remains in operation for all the time set after which, if it does not detect other movements, it switches off automatically.



**SL6/12**  
for 12Vdc LED

CE □ F ⊕ SELV ⚡

<b>Code</b>	0843501
<b>Input</b>	220 - 240Vac
<b>Output</b>	12Vdc
<b>Power</b>	0,5 - 6 W
<b>Input wiring</b>	2000mm with Europlug
<b>Output wiring</b>	500mm with MiniPlug distributor 4 connectors

12Vdc

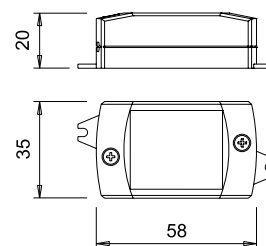

**FLAT 15/12**  
for 12Vdc LED

CE □ F ⊕ SELV ⚡

<b>Code</b>	0843301
<b>Input</b>	220 - 240Vac
<b>Output</b>	12Vdc
<b>Power</b>	1 - 15W
<b>Input wiring</b>	2000mm with Europlug
<b>Output wiring</b>	500mm with MiniPlug distributor 12 connectors

12Vdc

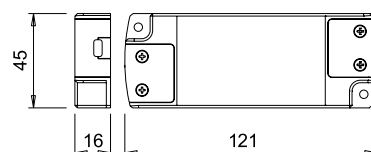

**SL6/24D**  
for 24Vdc LED

CE □ F ⊕ SELV ⚡

<b>Code</b>	0846601
<b>Input</b>	220 - 240Vac
<b>Output</b>	24Vdc
<b>Power</b>	0,5 - 7,2W
<b>Input wiring</b>	2000mm with Europlug
<b>Output wiring</b>	500mm with Micro24 distributor 6 connectors

24Vdc

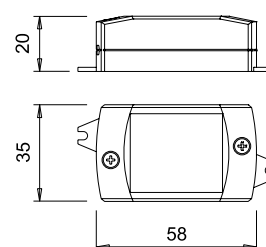

**FLAT 15/24D**  
for 24Vdc LED

CE □ F ⊕ SELV ⚡

<b>Code</b>	0846701
<b>Input</b>	220 - 240Vac
<b>Output</b>	24Vdc
<b>Power</b>	1 - 15W
<b>Input wiring</b>	2000mm with Europlug
<b>Output wiring</b>	500mm with Micro24 distributor 9 connectors

24Vdc

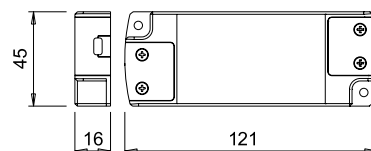





**SL30/12**  
for 12Vdc LED

CE □ F ⊕ SELV 🏠

<b>Code</b>	0839201
<b>Input</b>	220 - 240Vac
<b>Output</b>	12Vdc
<b>Power</b>	3 - 30W
<b>Input wiring</b>	2000mm with Europlug
<b>Output wiring</b>	500mm with Miniplug distributor 12 connectors

12Vdc

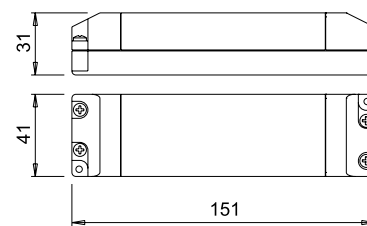

**SL30/24D**  
for 24Vdc LED

CE □ F ⊕ SELV 🏠

<b>Code</b>	0846501
<b>Input</b>	220 - 240Vac
<b>Output</b>	24Vdc
<b>Power</b>	3 - 30W
<b>Input wiring</b>	2000mm with Europlug
<b>Output wiring</b>	500mm with Micro24 distributor 9 connectors

24Vdc

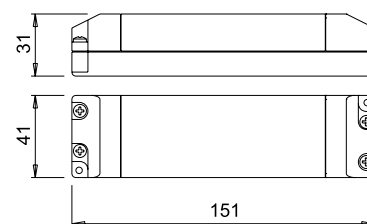

**SL6/350**  
for 350mA LED

CE □ F ⊕ SELV 🏠

<b>Code</b>	0841601
<b>Input</b>	220 - 240Vac
<b>Output</b>	350mA
<b>Power</b>	1 - 6 LED
<b>Input wiring</b>	2000mm with Europlug
<b>Output wiring</b>	500mm with BUS distributor 6 connectors

350mA

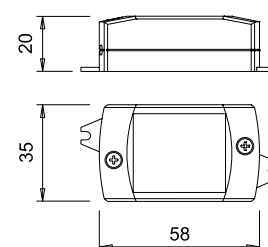

**FLAT 15/12 IP44**  
for 12Vdc LED

CE □ F ⚠ ⊕ SELV 🏠

<b>Code</b>	0840001
<b>Input</b>	220 - 240Vac
<b>Output</b>	12Vdc
<b>Power</b>	1 - 15W
<b>Input wiring</b>	2000mm with Europlug
<b>Output wiring</b>	500mm with Miniplug distributors 12 connectors

12Vdc

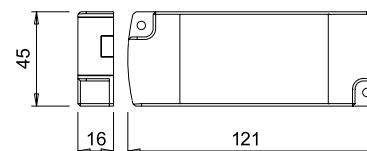

**IP44 SPLASH PROTECTION**  
FOR BATHROOMS  
APPLICATION

#### Appliance classification according to degree of electric shock protection



##### Insulation degree II

Appliances in which electric shock protection is provided, in addition to the basic insulation, by further or reinforced insulation (also known as double insulation). In this case, the appliance does not need to be connected to the mains earth.



##### Insulation degree III

This symbol identifies appliances that operate at low voltages (12 Volts, for example) and are therefore connected to extra safety low voltage power circuits. In this case too, the appliance does not need to be connected to the mains earth.

#### Appliance classification according to installation surface inflammability



##### Protection degree F

Appliances bearing the F symbol may be installed directly on normally inflammable surfaces. Normally inflammable surfaces are defined as surfaces made from materials such as wood or wood derivatives and which are more than 2 mm thick.

#### Appliance classification according to degree of protection against penetration by solids and liquids



##### Protection degree IP44

Protected against solid objects greater than 1mm. Protected against splashing water.

#### Other symbols



##### Independent transformer

This indicates that a transformer is approved for independent, exposed installation applications. In these cases, the transformer may be used immediately as is, without having to be incorporated into lighting units or additional casings.

SELV

##### SELV

This symbol indicates that the transformer complies with the European EN 61347-1 standard. The SELV symbol (Safety Extra Low Voltage) identifies a transformer in which touching the secondary circuit outputs, even if no lamps are connected, does not constitute a hazard.



##### Inside use

This symbol identifies appliances that are suitable only for inside use.

#### Norms and directives



##### CE

All the lighting appliances published in this catalog with the corresponding CE mark, have been designed and manufactured in compliance to EN 60598-1 European norm that is up to the international standard norm IEC 598-1. The CE mark indicates that the product is conforming and satisfies all the community directives that are applicable; it guarantees the right of this product to be freely commercialized in all the states members of the European Union.



##### WEEE (Waste of electric and electronic equipment)

All the lighting appliances published in this catalog with this corresponding mark, have been designed and manufactured in compliance UE Directive 2002/96/CE and 2003/108/CE. DOMUS Line marks with this symbol the products that are included in this directive and furnishes the relative procedures of disposal in the instructions sheet. DOMUS Line is registered to the ECOLIGHT national consortium for the collection of the end of life appliances.

### **Warranty**

Each unit is fully guaranteed for a period of 24 months from the date of delivery. From the warranty are excluded all defects caused by force majeure (lightning, fire, etc.), as well as any damage caused by improper use of equipment. The products must be installed and/or used in accordance with the specifications and instructions given by DOMUS Line Srl. They must also be installed and/or used in compliance with the provisions governing the installation and/or use of electric material force in the country where the products are installed and/or used. To this end, the buyer expressly releases DOMUS Line Srl from any responsibility for improper use, failure to comply with safety standards, technical specifications and instructions for use. The products which do not meet the standards and/or specifications in force in the European Union, will only be provided to the buyer that in the order specifies that the destination country does not belong to the European Union and indicating to have exhausted all the controls on compatibility of safety standards in force in the country outside the EU for which they are intended. In the absence of other arrangements for testing of the equipment, the standards established by the CEI (Italian Electrotechnical Committee) are valid. The warranty is void without fail in the event of tampering with the equipment by persons or technicians not specifically authorized by DOMUS Line Srl. The warranty does not cover normal wear and tear or the consequences of improper installation, nor the failure and/or breaks caused by inexperience and/or neglect.

### **Copyright**

#### **© 2015 DOMUS Line®**

The brand and name DOMUS Line are registered trademarks. DOMUS Line owns brand names and known and widely used logos. The brand names and logos published in this catalogue are registered or in any case subject to the laws on unregistered brand names. All reproduction or distribution by any means: photocopies, internet, microfilm or other means, total or partial, of this catalogue is forbidden without the written permission of DOMUS Line.

### **Patents**

The patented models, registered and published in this catalogue, are protected and counterfeiting will be prosecuted in accordance with the law.

### **Disclaimer**

This document is distributed as “uncontrolled” and DOMUS Line reserves the right to change the characteristics of the products to meet any technical or commercial needs, without prior notice. DOMUS Line verified the data published in this document with the utmost attention. However, because of the variables that exist between the development process and the publication of the catalog, DOMUS Line assumes no responsibility for errors, gaps in data, inaccuracies, and so on.



DOMUS Line®

DOMUS Line srl

Via Maestri del Lavoro, 1 I-33080 Porcia (PN) Italy

P. +39 0434 595911 F. +39 0434 923345

[info@domusline.com](mailto:info@domusline.com)

[www.domusline.com](http://www.domusline.com)