

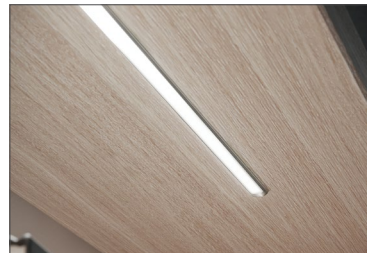

DOMUS Line®

APEX MISS LAB

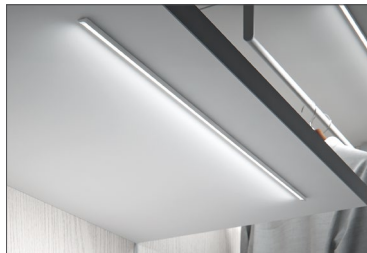



Luminaires for kitchens, living rooms and bedrooms



Architectural luminaires for bathrooms



Luminaires for classic furniture



Commercial lighting



Sensors and LED converters

DOMUS Line is an Italian company specialized in the **designing and production of lighting devices for the furniture industry**. Five brands put together the widest offer of lighting systems and control devices of the furniture lighting sector. Ongoing **research, innovation, design, reliability and brand reputation** are the distinctive values of our company.

Based near Venice in the North-East of Italy, in a region with strong industrial traditions, DOMUS Line is known the world throughout for its pragmatic approach, creativity and technological expertise.

A selected sales network distributes DOMUS Line appliances in over 70 countries in all continents, from the Americas to Oceania, guaranteeing the client expertise and assistance. The company's international commitment is constantly driven by its presence at both regional and international industry fairs.

DOMUS Line offers a wide range of lighting equipment certified according to the CE, UL, CSA, EAC, RCM schemes that enable its industrial and business partners to easily import and export products in the five continents.

DOMUS Line has been **ISO 9001** certified for many years and has entrusted its periodic audits to one the world's most prestigious entities. The **ISO 14001** environmental certification guarantees the company's commitment to continuous improvement and respect for the environment. DOMUS Line also adopts the OHSAS18001 standard (Occupational Health and Safety Assessment Specification) ensuring compliance with the requirements for the Management Systems of Health and Safety at Work.

DOMUS Line is also compliant to the voluntary and independent evaluation procedure called **SMETA** (Sedex Member Ethical Audit) and implements rigorously the basic ethical principles (**ETI**) in the company, convinced that a healthy and serene working environment is one of factors of business success.

The established collaboration with designers made possible the discovery of innovative ways and solutions that integrate the functionality the best Italian creativity. Innovation, design and environmental sustainability are values that are part of our DNA and that are perfectly expressed by the products.

APEX, MISS and LAB are linear LED light fittings, designed for flush and recessed installation, ideal for:

- › **WALK-IN CLOSETS**
- › **WARDROBE CABINETS**
- › **SHELVES**
- › **UNDER KITCHEN CABINETS**



FEATURES

• **HIGH PERFORMANCE**

APEX, MISS and LAB integrate a new generation of FLEXYLED with a **higher luminous flux (85 lm/W)** which guarantees that compartments and surfaces are excellently lit.



• **CONTROL OVER COLOUR TEMPERATURE**

The entire collection is available with **warm white** and **natural white** light sources. When manufacturing the LED strips, the light-emitting diodes are carefully selected and colour rendering index is over **Ra80**.

• **VISUAL COMFORT AND ENERGY EFFICIENCY**

Each fitting can be set up with two different LED strips:

FLEXYLED SHE 180 LED/m _ 14,4W/m @ 24Vdc (no-dot effect)



FLEXYLED HE 120 LED/m _ 9,6W/m @ 24Vdc



• **MICRO24 CONNECTION SYSTEM**

APEX, MISS and LAB come with the Micro24 connection system as standard, with connectors of small dimension (each socket has a diameter of just 6mm) and with safety clip.



CONFIGURATION

APEX HI

- recessed installation in a through milled groove
- groove width 9mm and depth 11mm
- length customised on request, min. 30cm - max. 3m
- recommended for vertical installation in the sides of closets, wardrobes, kitchen columns



APEX

- recessed installation in a blind milled groove
- groove width 9mm and depth 11mm
- length customised on request, min. 30cm - max. 3m
- recommended for horizontal installation under kitchen units and in open compartments, book shelves, equipped walls



APEX HI IR

- recessed installation in a through milled groove
- infrared proximity sensor
- on-off function (on when door opens - off when door closes)
- **APEX HI IR SXU-DXD** _ vertical profile with sensor at top left of door, or bottom right
- **APEX HI IR DXU-SXD** _ vertical profile with sensor at top right door, or bottom left
- sensitivity of sensor variable according to material of which door is made and its finish



APEX SD

- recessed installation in a blind milled groove
- electronic dimmable switch
- groove width 9mm and depth 11mm
- length customised on request, min. 30cm - max. 3m
- recommended for horizontal installation under kitchen unit and in open compartments, book shelves, equipped walls



MISS HI

- recessed installation in a through milled groove
- groove width 12,3mm and depth 13,5mm
- length customised on request, min. 30cm - max. 3m
- recommended for horizontal installation under kitchen units and in open compartments, book shelves, equipped walls



MISS

- recessed installation in a blind milled groove
- groove width 12,3mm and depth 13,5mm
- length customised on request, min. 30cm - max. 3m
- recommended for horizontal installation under kitchen units and in open compartments, book shelves, equipped walls



MISS HI IR

- recessed installation in a through milled groove
- groove width 12,3mm and depth 13,5mm
- length customised on request, min. 30cm - max. 3m
- **MISS HI IR SX** _ horizontal profile with sensor on left
- **MISS HI IR DX** _ horizontal profile with sensor on right
- recommended for horizontal installation inside kitchen units and wardrobe shelves



MISS SD

- recessed installation in a blind milled groove
- electronic dimmer switch
- groove width 12,3mm and depth 13,5mm
- length customised on request, min. 30cm - max. 3m
- recommended for horizontal installation under kitchen units and in open compartments, book shelves, equipped walls



LAB HI

- recessed installation in a through milled groove
- groove width 12,3mm and depth 13,5mm
- length customised on request, min. 30cm - max. 3m
- recommended for horizontal installation in open compartments, book shelves, equipped walls



LAB

- recessed installation in a blind milled groove
- groove width 12,3mm and depth 13,5mm
- length customised on request, min. 30cm - max. 3m
- recommended for horizontal installation under wardrobe cabinets, book shelves, equipped walls





APEX

DOMUS Line
design

LED profile in methacrylate for recessed installation

Materials:

PMMA, thermoplastic polymers

Finish:

white

Light sources:

HE LED module (120 LED/metre)

LED SHE module (180 LED/metre)

Installation:

vertical and horizontal recessed installation

Application type:

wardrobe, under cabinet, under shelf

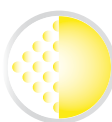

NO-DOT EFFECT TECHNOLOGY

The appliance can be configured with a high linear density SHE 180 LED/metre strip which eliminates the dot-effect of light emitting diodes.



IR SENSOR

The device can be set up with an infrared electronic sensor to turn the device on or off automatically upon opening and closing the door.



SD DIMMER SWITCH

The device can be set up with an infrared electronic switch that, with a simple movement of the hand near the sensor, allows the user to turn on, turn off and adjust the light intensity of the device.



APEX HI IR FOR THROUGH MILLED GROOVE



TECHNICAL DATA

Power supply	24Vdc
Wattage	HE 9,6 W/m - SHE 14,4 W/m
Wiring	2000mm
Connector	Micro24



PHOTOMETRIC DATA

FLEXYLED HE 120 LED/m _ 9,6W/m @ 24Vdc

Configuration	HE (120 LED/m)	
Colour appearance	natural white	
Colour temperature	4100 K	
Luminous efficiency	85 lm/W	
CRI	Ra ≥ 80	

* values referred to APEX HE 2000mm

Configuration	HE (120 LED/m)	
Colour appearance	warm white	
Colour temperature	2900 K	
Luminous efficiency	85 lm/W	
CRI	Ra ≥ 80	

* values referred to APEX HE 2000mm

FLEXYLED SHE 180 LED/m _ 14,4W/m @ 24Vdc (no-dot effect)

Configuration	SHE (180 LED/m)	
Colour appearance	natural white	
Colour temperature	4100 K	
Luminous efficiency	85 lm/W	
CRI	Ra ≥ 80	

* values referred to APEX SHE 2000mm

Configuration	SHE (180 LED/m)	
Colour appearance	warm white	
Colour temperature	2900 K	
Luminous efficiency	85 lm/W	
CRI	Ra ≥ 80	

* values referred to APEX SHE 2000mm

MODELS



APEX HI
without sensor for through milled groove

Basic configuration for installation in a through milled groove. Switching on and switching off can be managed with an external switch. See accessories on page 18.

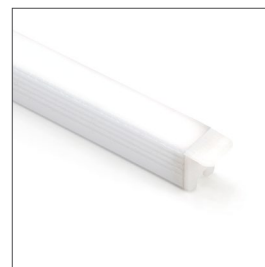

APEX
without sensor for blind milled groove

Basic configuration for installation in a blind milled groove. Switching on and switching off can be managed with an external switch. See accessories on page 18.



APEX HI IR
with IR sensor for through milled groove

It integrates an infrared proximity sensor. The device is turned on and off by opening and closing the door.

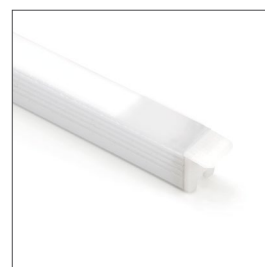

APEX SD
with SD switch for blind milled groove

APEX SD integrates an electronic infrared dimmer switch which allows to turning on, turning off and adjusting the light intensity.

IR AND SD CONFIGURATION



APEX HI IR with IR sensor for through milled groove

APEX HI IR has an infrared sensor with limit-switch function for installation in compartments. The device is turned on and off by opening and closing the door. The sensitivity of the sensor varies according to the material of which the door is made and its finish. Examples can be found in the table. For a detailed list visit www.domusline.com

Material	Finish	Distance
Laminate	dark oak	240mm
Varnished	bright white	260mm
Wood	natural	320mm
Glass	extra light serigraphy	140mm

LEFT OR RIGHT DOOR _ VERTICAL INSTALLATION



APEX HI IR SXU - DXD

Designed for vertical installation with sensor on the top back side of the left door, or with a sensor on the bottom back side of the right door.

EXAMPLE OF VERTICAL INSTALLATION WITH SENSOR ON TOP LEFT SIDE



APEX HI IR DXU - SXD

Designed for vertical installation with sensor on the top back side of the right door, or with a sensor on the bottom back side of the left door.

EXAMPLE OF VERTICAL INSTALLATION WITH SENSOR ON TOP RIGHT SIDE



EXAMPLE OF HORIZONTAL INSTALLATION



APEX SD with SD switch for blind milled groove

APEX SD integrates an electronic infrared dimmer switch which allows to turning on, turning off and adjusting the light intensity of the profile.

INSTALLATION

APEX is designed for recessed installation in a blind or through milled groove which is 9mm wide and 11mm deep.

APEX's unique shape hides the irregular edges of the groove. By making a 0.7mm chamfer at 45° is possible to reduce the protrusion out of the groove to only 0.4mm.

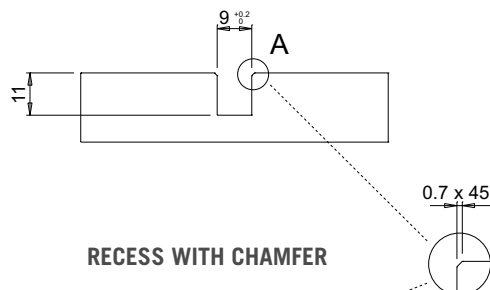

STANDARD RECESS

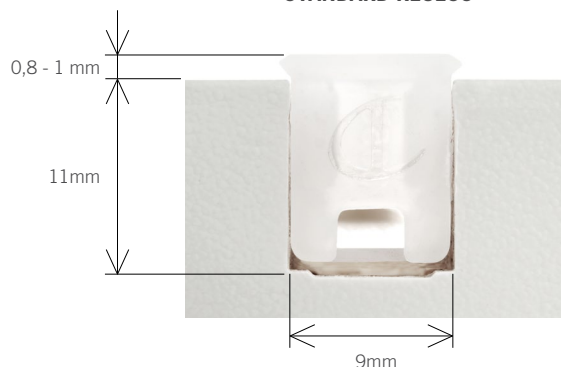

RECESS WITH CHAMFER

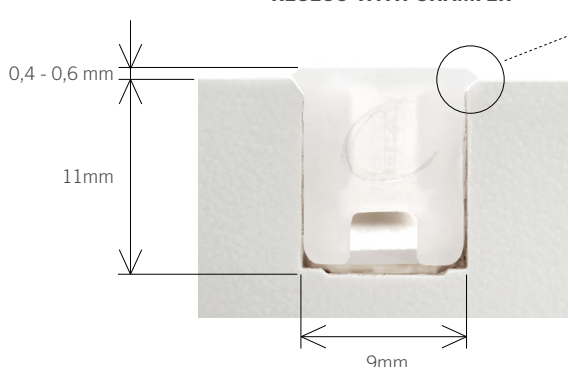

CODES AND DRAWINGS

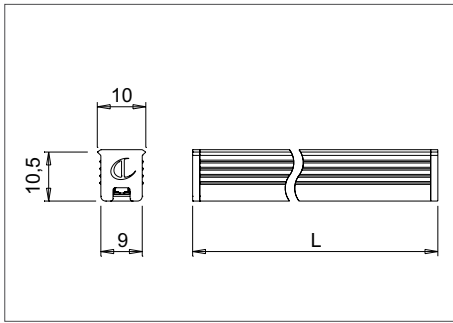

APEX HI

without sensor



Code	Model	Watt & Volt	Light colour	Finish
on request*	HE (120 LED/metro)	9,6W/m @ 24Vdc	natural white	O1 - white
on request*	HE (120 LED/metro)	9,6W/m @ 24Vdc	warm white	O1 - white
on request*	SHE (180 LED/metro)	14,4W/m @ 24Vdc	natural white	O1 - white
on request*	SHE (180 LED/metro)	14,4W/m @ 24Vdc	warm white	O1 - white

* codes will be provided according to measurement requested.

CONVERTER NOT INCLUDED. TO BE ORDERED SEPARATELY. See page 21.

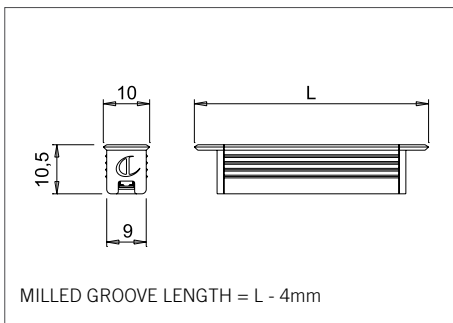

MILLED GROOVE LENGTH = L - 4mm

APEX

without sensor - with lateral heads for blind milled groove



Code	Model	Watt & Volt	Light colour	Finish
on request*	HE (120 LED/metro)	9,6W/m @ 24Vdc	natural white	O1 - white
on request*	HE (120 LED/metro)	9,6W/m @ 24Vdc	warm white	O1 - white
on request*	SHE (180 LED/metro)	14,4W/m @ 24Vdc	natural white	O1 - white
on request*	SHE (180 LED/metro)	14,4W/m @ 24Vdc	warm white	O1 - white

* codes will be provided according to measurement requested.

CONVERTER NOT INCLUDED. TO BE ORDERED SEPARATELY. See page 21.

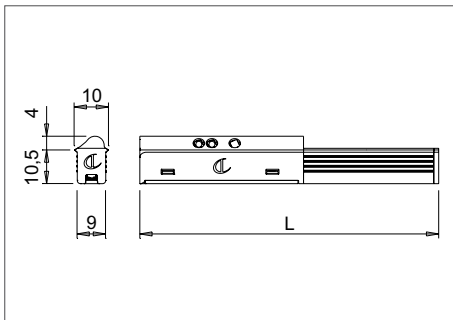

APEX HI IR SXU-DXD

with IR sensor on the top back side of left door or on bottom back side of right door - for a through milled groove



Code	Model	Watt & Volt	Light colour	Finish
on request*	HE (120 LED/metro)	9,6W/m @ 24Vdc	natural white	O1 - white
on request*	HE (120 LED/metro)	9,6W/m @ 24Vdc	warm white	O1 - white
on request*	SHE (180 LED/metro)	14,4W/m @ 24Vdc	natural white	O1 - white
on request*	SHE (180 LED/metro)	14,4W/m @ 24Vdc	warm white	O1 - white

* codes will be provided according to measurement requested.

CONVERTER NOT INCLUDED. TO BE ORDERED SEPARATELY. See page 21.

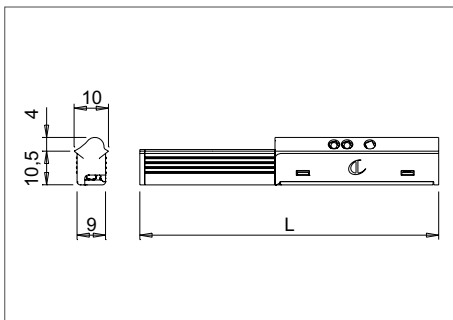

APEX HI IR DXU-SXD

with IR sensor on the top back side of right door or on bottom back side of left door - for a through milled groove



Code	Model	Watt & Volt	Light colour	Finish
on request*	HE (120 LED/metro)	9,6W/m @ 24Vdc	natural white	O1 - white
on request*	HE (120 LED/metro)	9,6W/m @ 24Vdc	warm white	O1 - white
on request*	SHE (180 LED/metro)	14,4W/m @ 24Vdc	natural white	O1 - white
on request*	SHE (180 LED/metro)	14,4W/m @ 24Vdc	warm white	O1 - white

* codes will be provided according to measurement requested.

CONVERTER NOT INCLUDED. TO BE ORDERED SEPARATELY. See page 21.

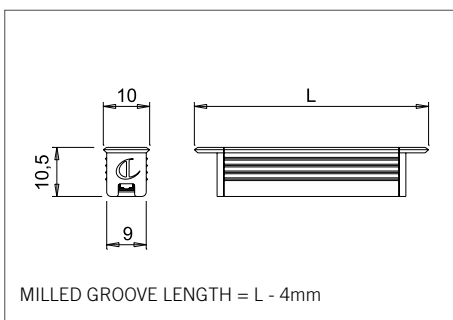

MILLED GROOVE LENGTH = L - 4mm

APEX SD

with electronic infrared dimmer switch and with lateral heads



Code	Model	Watt & Volt	Light colour	Finish
on request*	HE (120 LED/metro)	9,6W/m @ 24Vdc	natural white	O1 - white
on request*	HE (120 LED/metro)	9,6W/m @ 24Vdc	warm white	O1 - white
on request*	SHE (180 LED/metro)	14,4W/m @ 24Vdc	natural white	O1 - white
on request*	SHE (180 LED/metro)	14,4W/m @ 24Vdc	warm white	O1 - white

* codes will be provided according to measurement requested.

CONVERTER NOT INCLUDED. TO BE ORDERED SEPARATELY. See page 21.



MISS

Giuseppe Bavuso
design

LED profile in aluminium for recessed installation

Materials:

aluminium, PMMA, thermoplastic polymers

Finishes:

aluminium, brown, dark inox, dark gray

Light sources:

HE LED module (120 LED/metre)

SHE LED module (180 LED/metre)

Installation:

horizontal recessed installation

Application type:

under cabinet, under shelf

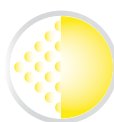

NO-DOT EFFECT TECHNOLOGY

The appliance can be configured with a high linear density SHE 180 LED/metre strip which eliminates the dot-effect of light emitting diodes.



IR SENSOR

The device can be set up with an infrared electronic sensor to turn the device on or off automatically upon opening and closing the door.



SD DIMMER SWITCH

The device can be set up with an infrared electronic switch that, with a simple movement of the hand near the sensor, allows the user to turn on, turn off and adjust the light intensity of the device.



MISS FOR BLIND MILLED GROOVE



TECHNICAL DATA

Power supply	24Vdc
Wattage	HE 9,6 W/m - SHE 14,4 W/m
Wiring	2000mm
Connector	Micro24



PHOTOMETRIC DATA

FLEXYLED HE 120 LED/m _ 9,6W/m @ 24Vdc

Configuration	HE (120 LED/m)
Colour appearance	natural white
Colour temperature	4100 K
Luminous efficiency	85 lm/W
CRI	Ra ≥ 80

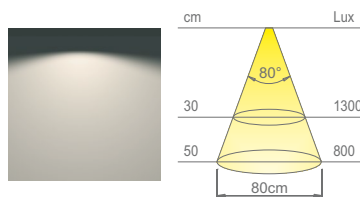

* values referred to MISS HE 2000mm

Configuration	HE (120 LED/m)
Colour appearance	warm white
Colour temperature	2900 K
Luminous efficiency	85 lm/W
CRI	Ra ≥ 80

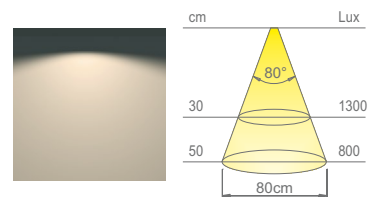

* values referred to MISS HE 2000mm

FLEXYLED SHE 180 LED/m _ 14,4W/m @ 24Vdc (no-dot effect)

Configuration	SHE (180 LED/m)
Colour appearance	natural white
Colour temperature	4100 K
Luminous efficiency	85 lm/W
CRI	Ra ≥ 80

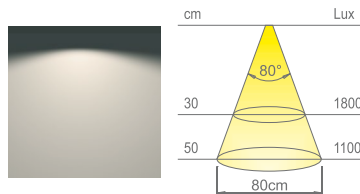

* values referred to MISS SHE 2000mm

Configuration	SHE (180 LED/m)
Colour appearance	warm white
Colour temperature	2900 K
Luminous efficiency	85 lm/W
CRI	Ra ≥ 80

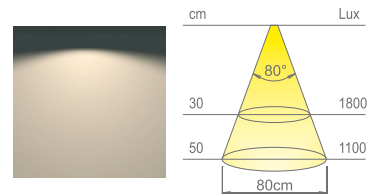

* values referred to MISS SHE 2000mm

MODELS



MISS HI
without sensor for through milled groove

Basic configuration for installation in a through milled groove. Switching on and switching off can be managed with an external switch. See accessories on page 18.



MISS
without sensor for blind milled groove

Basic configuration for installation in blind milled groove. Switching on and switching off can be managed with an external switch. See accessories on page 18.



MISS HI IR
with IR sensor for through milled groove

It integrates an infrared proximity sensor. Turning on and turning off are automatically activated by opening and closing the door.



MISS SD
with SD switch for blind milled groove

MISS SD integrates an electronic infrared switch which allows to turning on, turning off and adjusting the light intensity.

IR AND SD CONFIGURATION



MISS HI IR with IR sensor for through milled groove

MISS HI IR has an infrared sensor with limit-switch function for installation in compartments. Connected devices are turned on and off automatically by opening and closing the door. The sensitivity of the sensor varies according to the material of which the door is made and its finish. Examples can be found in the table. For a detailed list visit www.domusline.com

Material	Finish	Distance
laminated	dark oak	240mm
varnished	bright white	260mm
wood	natural	320mm
glass	extra light serigraphy	140mm

LEFT OR RIGHT _ HORIZONTAL INSTALLATION



MISS HI IR SX

Designed for installation on horizontal shelf with sensor on left side.



MISS HI IR DX

Designed for installation on horizontal shelf with sensor on right side.

EXAMPLE OF HORIZONTAL INSTALLATION WITH SENSOR ON LEFT SIDE

EXAMPLE OF HORIZONTAL INSTALLATION WITH SENSOR ON RIGHT SIDE

MISS SD with SD switch for blind milled groove



MISS SD integrates an electronic infrared dimmer switch which allows to turning on, turning off and adjusting the light intensity of the profile.

INSTALLATION

MISS is designed for installation in a blind or through milled groove which is 12,3mm wide and 13,5mm deep.

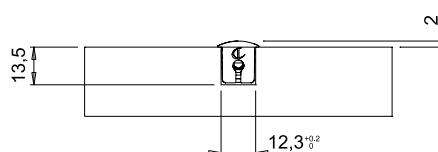

FINISHES



ALUMINIUM (code 05)

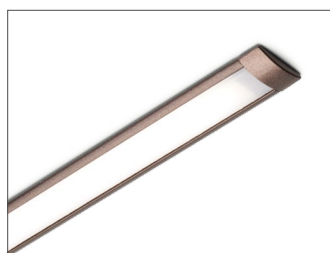

BROWN (code 39)



DARK INOX (code 50)



DARK GRAY (code 32)

CODES AND DRAWINGS

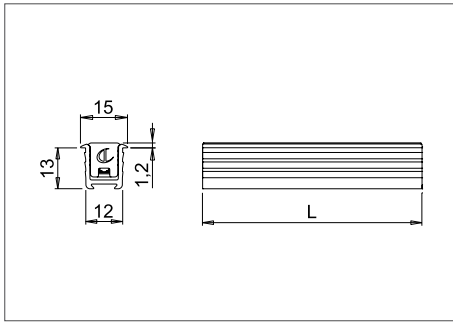

MISS HI

without sensor



Code	Model	Watt & Volt	Light colour	Finish
on request*	HE (120 LED/metro)	9,6W/m @ 24Vdc	natural white	see finishes on page 12
on request*	HE (120 LED/metro)	9,6W/m @ 24Vdc	warm white	see finishes on page 12
on request*	SHE (180 LED/metro)	14,4W/m @ 24Vdc	natural white	see finishes on page 12
on request*	SHE (180 LED/metro)	14,4W/m @ 24Vdc	warm white	see finishes on page 12

* codes will be provided according to measurement requested.

CONVERTER NOT INCLUDED. TO BE ORDERED SEPARATELY. See page 21.

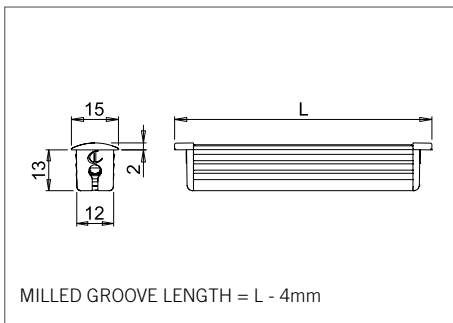

MISS

without sensor - with lateral heads for blind milled groove



Code	Model	Watt & Volt	Light colour	Finish
on request*	HE (120 LED/metro)	9,6W/m @ 24Vdc	natural white	see finishes on page 12
on request*	HE (120 LED/metro)	9,6W/m @ 24Vdc	warm white	see finishes on page 12
on request*	SHE (180 LED/metro)	14,4W/m @ 24Vdc	natural white	see finishes on page 12
on request*	SHE (180 LED/metro)	14,4W/m @ 24Vdc	warm white	see finishes on page 12

* codes will be provided according to measurement requested.

CONVERTER NOT INCLUDED. TO BE ORDERED SEPARATELY. See page 21.

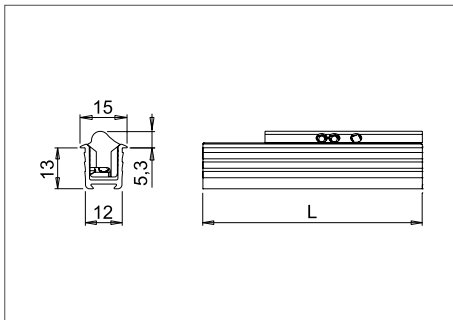

MISS HI IR SX

with IR sensor on left side for horizontal installation in a through milled groove



Code	Model	Watt & Volt	Light colour	Finish
on request*	HE (120 LED/metro)	9,6W/m @ 24Vdc	natural white	see finishes on page 12
on request*	HE (120 LED/metro)	9,6W/m @ 24Vdc	warm white	see finishes on page 12
on request*	SHE (180 LED/metro)	14,4W/m @ 24Vdc	natural white	see finishes on page 12
on request*	SHE (180 LED/metro)	14,4W/m @ 24Vdc	warm white	see finishes on page 12

* codes will be provided according to measurement requested.

CONVERTER NOT INCLUDED. TO BE ORDERED SEPARATELY. See page 21.

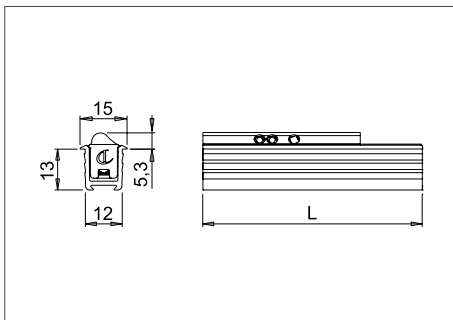

MISS HI IR DX

with IR sensor on right side for horizontal installation in a through milled groove



Code	Model	Watt & Volt	Light colour	Finish
on request*	HE (120 LED/metro)	9,6W/m @ 24Vdc	natural white	see finishes on page 12
on request*	HE (120 LED/metro)	9,6W/m @ 24Vdc	warm white	see finishes on page 12
on request*	SHE (180 LED/metro)	14,4W/m @ 24Vdc	natural white	see finishes on page 12
on request*	SHE (180 LED/metro)	14,4W/m @ 24Vdc	warm white	see finishes on page 12

* codes will be provided according to measurement requested.

CONVERTER NOT INCLUDED. TO BE ORDERED SEPARATELY. See page 21.

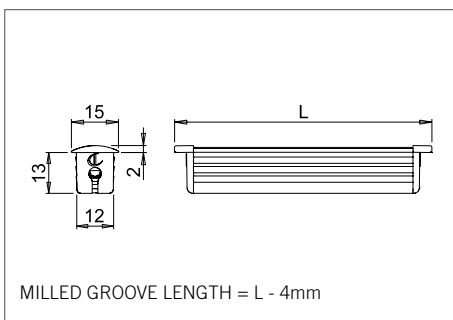

MISS SD

with electronic infrared dimmer switch and with lateral heads for installation in a blind milled groove



Code	Model	Watt & Volt	Light colour	Finish
on request*	HE (120 LED/metro)	9,6W/m @ 24Vdc	natural white	see finishes on page 12
on request*	HE (120 LED/metro)	9,6W/m @ 24Vdc	warm white	see finishes on page 12
on request*	SHE (180 LED/metro)	14,4W/m @ 24Vdc	natural white	see finishes on page 12
on request*	SHE (180 LED/metro)	14,4W/m @ 24Vdc	warm white	see finishes on page 12

* codes will be provided according to measurement requested.

CONVERTER NOT INCLUDED. TO BE ORDERED SEPARATELY. See page 21.



LAB

Giuseppe Bavuso
design

LED aluminium profile with anti-glare eyelid for recessed installation

Materials:

aluminium, PMMA, thermoplastic polymers

Finishes:

aluminium, brown, dark inox, dark gray

Light sources:

HE LED module (120 LED/metre)

SHE LED module (180 LED/metre)

Installation:

horizontal recessed installation

Application type:

wardrobe and walk-in closet

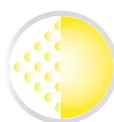

NO-DOT EFFECT TECHNOLOGY

The appliance can be configured with a high linear density SHE 180 LED/metre strip which eliminates the dot-effect of light emitting diodes.



LAB FOR BLIND MILLED GROOVE



TECHNICAL DATA

Power supply	24Vdc
Wattage	HE 9,6 W/m - SHE 14,4 W/m
Wiring	2000mm
Connector	Micro24



PHOTOMETRIC DATA

FLEXYLED HE 120 LED/m _ 9,6W/m @ 24Vdc

Configuration	HE (120 LED/m)	
Colour appearance	natural white	
Colour temperature	4100 K	
Luminous efficiency	85 lm/W	
CRI	Ra ≥ 80	

* values referred to LAB HE 2000mm

Configuration	HE (120 LED/m)	
Colour appearance	warm white	
Colour temperature	2900 K	
Luminous efficiency	85 lm/W	
CRI	Ra ≥ 80	

* values referred to LAB HE 2000mm

FLEXYLED SHE 180 LED/m _ 14,4W/m @ 24Vdc (no-dot effect)

Configuration	SHE (180 LED/m)	
Colour appearance	natural white	
Colour temperature	4100 K	
Luminous efficiency	85 lm/W	
CRI	Ra ≥ 80	

* values referred to LAB SHE 2000mm

Configuration	SHE (180 LED/m)	
Colour appearance	warm white	
Colour temperature	2900 K	
Luminous efficiency	85 lm/W	
CRI	Ra ≥ 80	

* values referred to LAB SHE 2000mm

MODELS



LAB HI
without sensor for through milled groove

Basic configuration for installation in a through milled groove. Switching on and switching off can be managed with an external switch. See accessories on page 18.



LAB
without sensor for blind milled groove

Basic configuration for installation in a blind milled groove. Switching on and switching off can be managed with an external switch. See accessories on page 18.



LAB has a special eyelid designed to eliminate the glare effect. Light projection is screened from the user and directed towards the inside of the lit compartment.

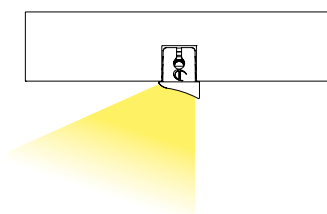

INSTALLATION

LAB is designed for installation in a blind or through milled groove which is 12,3mm wide and 13,5mm deep.

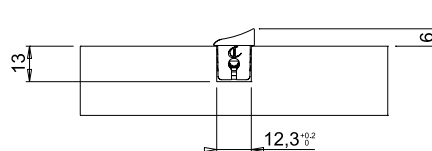

FINISHES



ALUMINIUM (code 05)



BROWN (code 39)



DARK INOX (code 50)



DARK GRAY (code 32)

CODES AND DRAWINGS

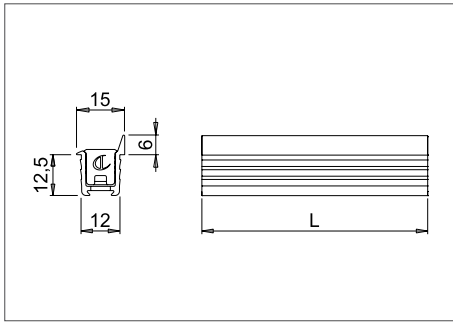

LAB HI
without sensor



Code	Model	Watt & Volt	Light colour	Finish
on request*	HE (120 LED/metro)	9,6W/m @ 24Vdc	natural white	see finishes on page 16
on request*	HE (120 LED/metro)	9,6W/m @ 24Vdc	warm white	see finishes on page 16
on request*	SHE (180 LED/metro)	14,4W/m @ 24Vdc	natural white	see finishes on page 16
on request*	SHE (180 LED/metro)	14,4W/m @ 24Vdc	warm white	see finishes on page 16

* codes will be provided according to measurement requested.

CONVERTER NOT INCLUDED. TO BE ORDERED SEPARATELY. See page 21.

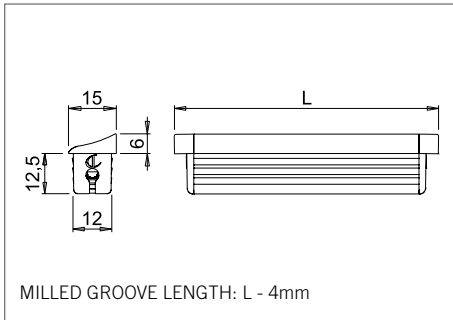

LAB
without sensor - with lateral heads for blind milled groove



Code	Model	Watt & Volt	Light colour	Finish
on request*	HE (120 LED/metro)	9,6W/m @ 24Vdc	natural white	see finishes on page 16
on request*	HE (120 LED/metro)	9,6W/m @ 24Vdc	warm white	see finishes on page 16
on request*	SHE (180 LED/metro)	14,4W/m @ 24Vdc	natural white	see finishes on page 16
on request*	SHE (180 LED/metro)	14,4W/m @ 24Vdc	warm white	see finishes on page 16

* codes will be provided according to measurement requested.

CONVERTER NOT INCLUDED. TO BE ORDERED SEPARATELY. See page 21.



CALL ME FW
wireless dimmer switch



Code	Input	Output	Load	Finish
1750801	12 - 24Vdc	12 - 24Vdc	36 - 72W	white
1750810	12 - 24Vdc	12 - 24Vdc	36 - 72W	aluminium
1750819	12 - 24Vdc	12 - 24Vdc	36 - 72W	steel

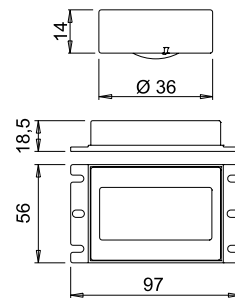

white

aluminium

steel

How CALL ME FW 2.0 works

Switching on and switching off take place by pressing the remote control key. A short flicker means the device is at its brightest. Memory Level, Safety Switch Off and Auto On functions are included.



On request, two holders for recessed installation available:
2011601 white
2011610 aluminium
2011619 steel



DOT IR FW
infrared proximity sensor



Code	Input	Output	Load	Finish
1752805	12 - 24Vdc	12 - 24Vdc	36 - 72W	aluminium

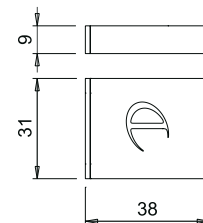

How DOT IR FW works

Devices connected to DOT IR FW are turned on and off automatically by opening and closing the door, onto the back of which the sensor is installed.



DOT IR FW can be installed with a holder or with an adhesive strip (both provided as standard).



IFR V09
PIR sensor



Code	Input	Output	Load	Finish
0854501	220 - 240 Vac	220 - 240 Vac	150 - 200W	white

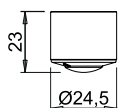
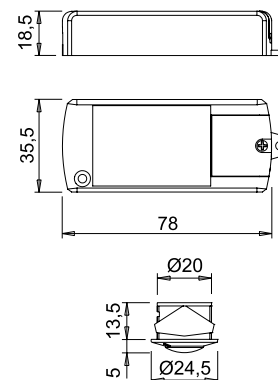

Surface installation with spacer sold separately. code 3055401

How IFR V09 works

On and off operated by temperature changes tracking together with the movement within the sensor's range. Switch-off delay can be set to anywhere between a minimum of 3 seconds and a maximum of 3 minutes.



IR 2.0 FW

infrared sensor with limit-switch, on-off and dimmer function



Code	Input	Output	Load	Set-up
0854401	12 - 24Vdc	12 - 24Vdc	30 - 60W	limit mode
0858601	12 - 24Vdc	12 - 24Vdc	30 - 60W	on/off + dimmer

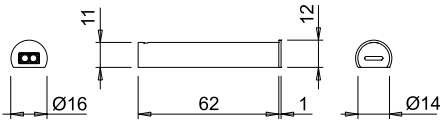

surface installation

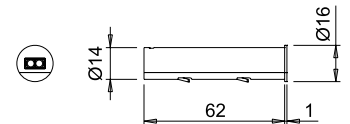

recessed installation

How IR 2.0 works

In limit mode, on and off are controlled by opening and closing the door, onto the back of which the sensor is installed. In on-off and dimmer modes, the user can turn on, turn off or adjust brightness with a movement of the hand close to the sensor. The IR 2.0 set up can be changed by pressing the micro switch on the back of the sensor.

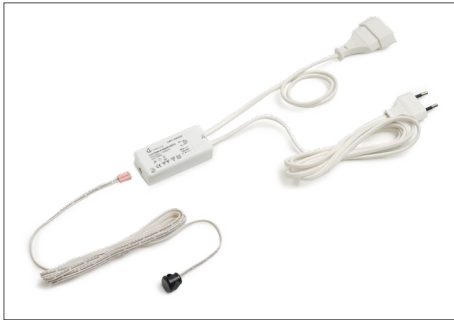

LIMIT

infrared proximity sensor



Code	Ref.	Model	Input	Output	Load	Finish
0835101	A	recess	220 - 240Vac	220 - 240Vac	150 - 250W	black
0835101B	B	surface	220 - 240Vac	220 - 240Vac	150 - 250W	white
0835105B	B	surface	220 - 240Vac	220 - 240Vac	150 - 250W	aluminium

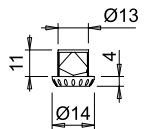

A - recessed installation

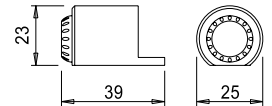

B - surface installation

How LIMIT works

Devices connected to LIMIT are turned on and off automatically by opening and closing the door, onto the back of which the sensor is installed. The LIMIT sensor can be installed in a recess (A) or on surface (B).



MULTI LIMIT

proximity multi-sensor



Code	Ref.	Model	Input	Output	Load	Finish
0838301	A	control unit	220 - 240Vac	220 - 240Vac	150 - 250W	black
1731703/S	B	recess sensor		-	-	black
1731903/S	C	surface sensor 20°		-	-	black



How MULTI LIMIT works

MULTI LIMIT is a limit infrared proximity sensor with multiple photocells (max. 3 sensors). Turns on when at least one door is open. Turns off only when all doors are closed. Sensors available for recess (A) and surface with photocell inclined at 20° (B).

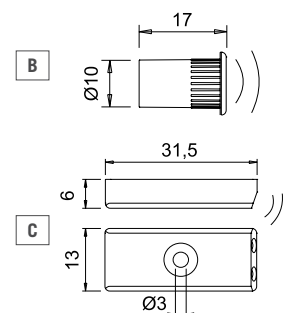



COMBO FW
proximity multi-sensor



Code	Ref.	Model	Input	Output	Load	Finish
0864003	A	control unit	12 - 24Vdc	12 - 24Vdc	30 - 60W	black
1731703/S	B	recess sensor	-	-	-	black
1731903/S	C	surface sensor 20°	-	-	-	black



B

C

How COMBO FW works

COMBO is a limited infrared proximity sensor with multiple independent photocells (max. 3 sensors). Devices connected to COMBO are turned on and off automatically by opening and closing the door, onto the back of which the sensor is installed. COMBO can be set up in three ways. Sensors available for recess (B) and surface with photocell inclined at 20° (C).

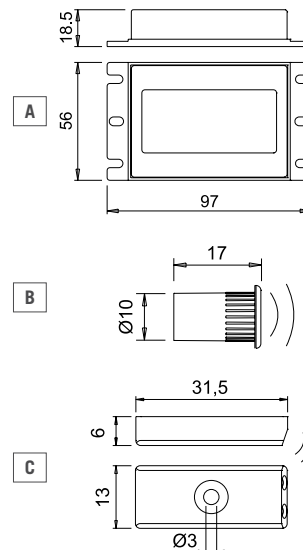

COMBO CAN BE SET UP IN THREE WAYS.

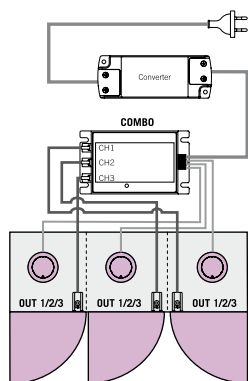

PROGRAMME 1 – COMMON SWITCHING ON

This set up allows all devices connected to COMBO to be turned on and off simultaneously. The device or group of devices turns on when any of the doors are open and turns off only when all doors are closed.

PROGRAMME 2 – TWO INDEPENDENT SWITCHING ON

This set up allows two devices or two groups to be turned on independently. The group with two sensors will turn on when any of the doors are open, and turns off only when all doors are closed. The third sensor works independently from the other two. Turning on and turning off are controlled by opening and closing the door, onto the back of which the third sensor is installed.

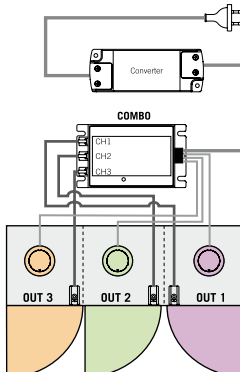
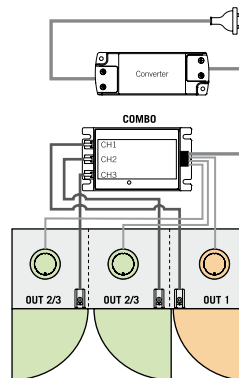

PROGRAMME 3 –THREE INDEPENDENT SWITCHING ON

This set up allows three devices or group of devices to be turned on independently. Each sensor can turn on or off independently the device or group of devices to which it is connected. Turning on and turning off are operated by opening or closing the door, onto the back of which each sensor is installed.

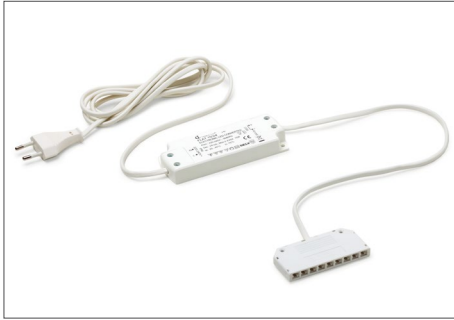

FLAT 15/24D

CE □ ⊕ SELV 🏠

Code	0846701
Input	220 - 240 Vac
Output	24Vdc
Load	15W
Input wiring	2000mm with Europlug
Output wiring	500mm Micro24 distributor with 9 connections

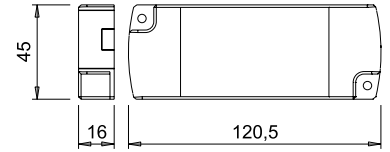

230V 24Vdc Micro 24



ST30/24D

CE □ ⊕ SELV 🏠

Code	0859101
Input	220 - 240 Vac
Output	24Vdc
Load	30W
Input wiring	2000mm with Europlug
Output wiring	500mm Micro24 distributor with 9 connections

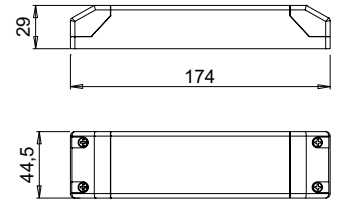

230V 24Vdc Micro 24



SL60/24D

CE □ ⊕ SELV 🏠

Code	0858801
Input	220 - 240 Vac
Output	24Vdc
Load	60W
Input wiring	2000mm with Europlug
Output wiring	500mm Micro24 distributor with 9 connections

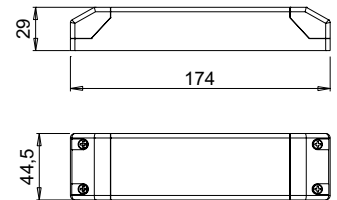

230V 24Vdc Micro 24



LEO 100/24D

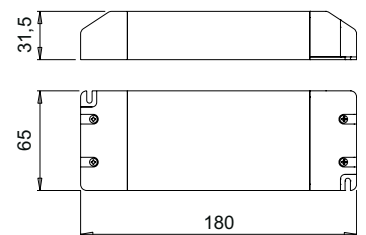

CE □ ⊕ SELV 🏠

Code	0856001
Input	220 - 240 Vac
Output	24Vdc
Load	100W
Input wiring	2000mm with Europlug
Output wiring	500mm Micro24 distributor with 9 connections



230V 24Vdc Micro 24



Appliance classification according to degree of electric shock protection

	Class I luminaire	Luminaire in which protection against electric shock does not rely on basic insulation only, but which includes an additional safety precaution in such a way that means are provided for the connection of accessible conductive parts to the protective (earthing) conductor in the fixed wiring of the installation in such a way that accessible conductive parts cannot become live in the event of a failure of the basic insulation.
	Class II luminaire	Luminaire in which protection against electric shock does not rely on basic insulation only, but in which additional safety precautions such as double insulation or reinforced insulation are provided, there being no provision for protective earthing or reliance upon installation conditions.
	Class III luminaire	Luminaire in which protection against electric shock relies on supply at safety extra-low voltage (SELV) and in which voltages higher than those of SELV are not generated.



Appliance classification according to degree of protection against penetration by solids and liquids

IP44	Protection degree IP44	Protected against solid objects greater than 1mm. Protected against splashing water.
-------------	-------------------------------	--

Other symbols

	Independent lamp controlgear	Lamp controlgear consisting of one or more separate elements so designed that it can be mounted separately outside a luminaire, with protection according to the marking of the lamp controlgear and without any additional enclosure.
SELV	Safety Extra Low Voltage	ELV (voltage which does not exceed 50 V a.c. r.m.s. or 120 V ripple free d.c. between conductors, or between any conductor and earth voltage band I of IEC 60449) in a circuit which is insulated from the mains supply by an insulation not less than that between the primary and secondary circuits of a safety isolating transformer according to IEC 61558-2-6 or equivalent.
	Indoor use	Equipment designed for indoor use only.

Norms and directives

	CE	All the lighting appliances published in this catalog with the corresponding CE mark, have been designed and manufactured in compliance to the applicable European Directive (2014/30/EU, 2014/35/EU, 2011/65/EU). It guarantees the right of this product to be freely commercialized in all the states members of the European Union. DOMUS Line guarantee the compliance following the demand of the European-EN technical standard (and consequently international-IEC).
	WEEE (Waste of electric and electronic equipment)	The product must be disposed of separately from household waste. The item should be handed for recycling centers according the local environmental rule for waste disposal. Appropriate separate collection of waste contributes to preventing negative effects on the environment and health and it encourages the reuse and/or recycling of materials. Illegal disposal entails the application of administrative sanctions provided by local law.

NOTE: All DOMUS Line luminaires are suitable for direct mounting on normally flammable surfaces such as that of the furniture.

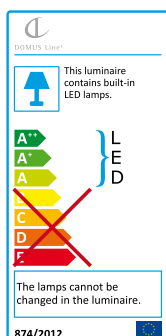

Devices with non-replaceable LED module
 Energy efficiency class: A++, A+, A
 EU Directive 2009/125/EC and relative Regulation : No. 1194/2012/UE, No. 1428/2015/UE.

Warranty

Each unit is fully guaranteed for a period of 24 months from the date of delivery. From the warranty are excluded all defects caused by force majeure (lightning, fire, etc.), as well as any damage caused by improper use of equipment. The products must be installed and/or used in accordance with the specifications and instructions given by DOMUS Line Srl. They must also be installed and/or used in compliance with the provisions governing the installation and/or use of electric material force in the country where the products are installed and/or used. To this end, the buyer expressly releases DOMUS Line Srl from any responsibility for improper use, failure to comply with safety standards, technical specifications and instructions for use. The products which do not meet the standards and/or specifications in force in the European Union, will only be provided to the buyer that in the order specifies that the destination country does not belong to the European Union and indicating to have exhausted all the controls on compatibility of safety standards in force in the country outside the EU for which they are intended. In the absence of other arrangements for testing of the equipment, the standards established by the CEI (Italian Electrotechnical Committee) are valid. The warranty is void without fail in the event of tampering with the equipment by persons or technicians not specifically authorized by DOMUS Line Srl. The warranty does not cover normal wear and tear or the consequences of improper installation, nor the failure and/or breaks caused by inexperience and/or neglect.

scan for general conditions of sale ►



Copyright

© 2017 DOMUS Line®

The brand and name DOMUS Line are registered trademarks. DOMUS Line owns brand names and known and widely used logos. The brand names and logos published in this catalogue are registered or in any case subject to the laws on unregistered brand names. All reproduction or distribution by any means: photocopies, internet, microfilm or other means, total or partial, of this catalogue is forbidden without the written permission of DOMUS Line.

Patents

The patented models, registered and published in this catalogue, are protected and counterfeiting will be prosecuted in accordance with the law.

Disclaimer

This document is distributed as “uncontrolled” and DOMUS Line reserves the right to change the characteristics of the products to meet any technical or commercial needs, without prior notice. DOMUS Line verified the data published in this document with the utmost attention. However, because of the variables that exist between the development process and the publication of the catalogue, DOMUS Line assumes no responsibility for errors, gaps in data, inaccuracies, and so on.



DOMUS Line®

DOMUS Line srl

Via Maestri del Lavoro, 1 I-33080 Porcia (PN) Italy

P. +39 0434 595911 F. +39 0434 923345

info@domusline.com

www.domusline.com