

Sistema di assemblaggio HOUSING Ø14

Connecting fitting HOUSING Ø14

Barilotto Ø14 con bordo Housing Ø14 w/cover rim

Materiale - Material > Zama - Zinc Alloy

Finitura - Finish > ZL - ZZ - ZZN - ZBR

Art.	Ø	Øa	H	M	i			
B007	14	16	13	M8	8	16	2.000	11,2
B001	14	16	14	M8	9	18	2.000	11,4
B008	14	16	15	M8	10	20	2.000	11,8
B024	14	16	16	M8	11	22	2.000	11,9
B030	14	16	17,5	M8	12,5	25	1.250	9,1
B014	14	16	13	M8X1	8	16	su richiesta on request	
B015	14	16	14	M8X1	9	18	2.000	11,4

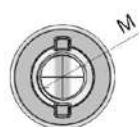
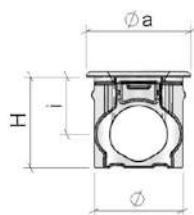

Connecting fitting HOUSING Ø14

Barilotto plus Ø14 con bordo Housing plus Ø14 w/cover rim

Materiale - Material > Zama - Zinc Alloy

Finitura - Finish > ZL - ZZ - ZZN - ZBR

Art.	Ø	Øa	H	M	i			
B060	14	16	14	M8	9	18	2.000	13,3

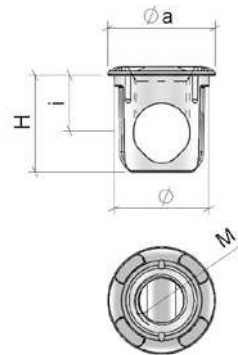
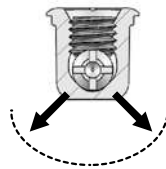

Sistema di assemblaggio HOUSING Ø12/14

Connecting fitting HOUSING Ø12/14

Tirante Ø7/Ø8 Dowel Ø7/Ø8

Materiale - Material > Ferro - Steel

Finitura - Finish > FZ

Art.	Ø	L	L1	M	i1	F		
TF01	7	8,5	25	M6	18,5	20	2.000	14,6
TF02	7	8,5	26,5	M6	20	21,5	2.000	15,5
TF03	7	8,5	35	M6	28,5	30	1.000	10,4
TF04	7	8,5	36,5	M6	30	31,5	1.000	11,0
TF12	7	8,5	26,5	6euro	20	21,5	2.000	16,5
TF16	7	8,5	33,5	6euro	27	28,5	2.000	20,4
TF11	8	8,5	35,5	M8	20	21,5	1.000	10,6
TF56	8	8,5	36,5	M6	21	22,5	1.250	12,5

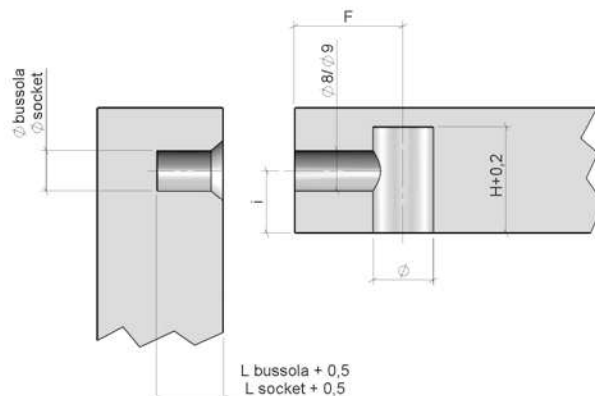
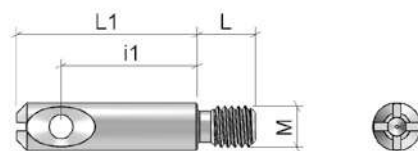

Connecting fitting HOUSING Ø12/14

Grano M8 “Basic” Conic screw M8 “Basic”

Materiale - Material > Zama - Zinc Alloy

Finitura - Finish > ZL -ZZ -ZZN

Art.	M	H		
GR09	M8	8	10.000	9,3
GR01	M8	10	10.000	13,5
GR12	M8x1	10	10.000	15,8
GR15	M8x1	12	5.000	8,0

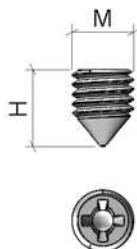

Grano M8 “Extra” Conic screw M8 “Extra”

Materiale - Material > Zama - Zinc Alloy

Finitura - Finish > ZL -ZZ -ZZN

Art.	M	H		
GR81	M8	8,2	10.000	13,0
GR17	M8	11,5	5.000	8,5

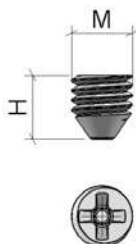



Sistema di assemblaggio HOUSING

Connecting fitting HOUSING

Tirante per vite rullata Dowel for hanger bolt

Materiale - Material > Ferro - Steel

Finitura - Finish > FZ

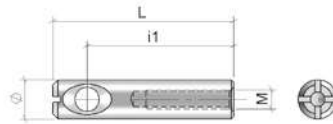

Art.	Ø	L	i1	M	F		
TF10	8	37	30	M4	31,5	1.000	10,2



Vite rullata Hanger bolt

Materiale - Material > Ferro - Steel

Finitura - Finish > FZ



Art.	M	L		
VR44	M4	40	5.000	13,7



Tirante doppio Double dowel

Materiale - Material > Ferro - Steel

Finitura - Finish > FZ

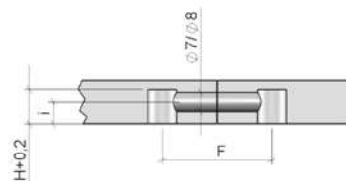
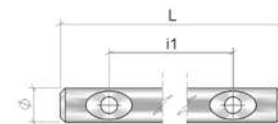

Art.	Ø	L	i1	F		
TFD70	7	62	42	45	1.000	15,5
TFD82	7	56	42	45	1.000	14,8
TFD84	7	52	37	40	500	6,6



Tirante doppio ad angolo Ø7 Angle double dowel Ø7

Materiale - Material > Ferro - Steel

Finitura - Finish > FZ

Art.	Ø	L	i1		
TFD71	7	45	39,5	1.000	17,0



Schema e tabella di foratura in Appendice A
Drilling pattern and drilling table in Appendix A

Appendix A

Tirante doppio ad angolo Ø7 Angle double dowel Ø7

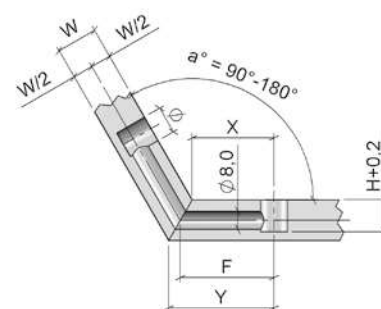

Art. TFD71		W=14 mm		W=16 mm		W=18 mm		W=22 mm		W=25 mm		W=29 mm		W=35 mm	
a [°]	F	X	Y	X	Y	X	Y	X	Y	X	Y	X	Y	X	Y
90	41	34,0	48,0	33,0	49,0	32,0	50,0	30,0	52,0	28,5	53,5	26,5	55,5	23,5	58,5
100	41	35,1	46,9	34,3	47,7	33,4	48,6	31,8	50,2	30,5	51,5	28,8	53,2	26,3	55,7
110	41	36,1	45,9	35,4	46,6	34,7	47,3	33,3	48,7	32,2	49,8	30,8	51,2	28,7	53,3
120	41	37,0	45,0	36,4	45,6	35,8	46,2	34,6	47,4	33,8	48,2	32,6	49,4	30,9	51,1
130	41	37,7	44,3	37,3	44,7	36,8	45,2	35,9	46,1	35,2	46,8	34,2	47,8	32,8	49,2
135	41	38,1	43,9	37,7	44,3	37,3	44,7	36,4	45,6	35,8	46,2	35,0	47,0	33,8	48,2
140	41	38,5	43,5	38,1	43,9	37,7	44,3	37,0	45,0	36,5	45,5	35,7	46,3	34,6	47,4
150	41	39,1	42,9	38,9	43,1	38,6	43,4	38,1	43,9	37,7	44,3	37,1	44,9	36,3	45,7
160	41	39,8	42,2	39,6	42,4	39,4	42,6	39,1	42,9	38,8	43,2	38,4	43,6	37,9	44,1
170	41	40,4	41,6	40,3	41,7	40,2	41,8	40,0	42,0	39,9	42,1	39,7	42,3	39,5	42,5
180	41	41,0	41,0	41,0	41,0	41,0	41,0	41,0	41,0	41,0	41,0	41,0	41,0	41,0	41,0