

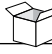

MATERIALE - MATERIAL - MATIÈRE
FERRO (STEEL) (ACIER)

FINITURA - FINISH - FINITION
FNL

Vite femmina Ø5.

Female screw Ø 5.
Vis femelle Ø 5.

Art.	Ø	L	M		
VF35	5	13,5	M4	5.000	9,2

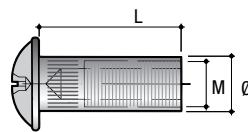



MATERIALE - MATERIAL - MATIÈRE
Ferro (Steel) (Acier)

FINITURA - FINISH - FINITION
FNL

Vite TBL.

Male screw TBL.
Vis mâle TBL.

Art.	Ø	L	M		
VC35	5	27	M4	5.000	16,3

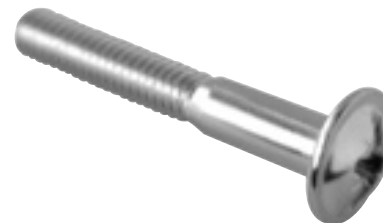
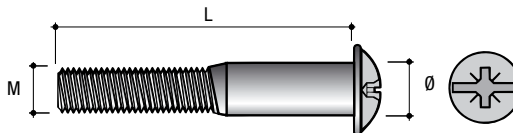

Cerniere asimmetriche



Foldable hinges • Charnières asymétriques

MATERIALE - MATERIAL - MATIÈRE
Ferro (Steel) (Acier)

FINITURA - FINISH - FINITION
FZ

Cerniera asimmetrica.

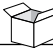
Foldable hinge.
Charnière asymétrique à visser.

Art.	D	L	i	i1	Ø		
CE01	32	50	20	9	6	800	19,5

